

Proiettore industriale IP66 ATEX BC9307S LED

VoltNexT



Ex marking: Ex db e IIC T4/T3 Gb
Ex tb IIC T130°C/T195°C Db,IP66

Application

- Ideal to be used in the oilfield, chemical industry, offshore drilling platform, steel industry, petroleum etc.
- Gas explosive environment: Group IIA, IIB, IIC.
- Zone 1, zone 2; zone 21, zone 22.



Characteristics

- It is made using a special aluminum housing, all exposed fasteners and bracket adopt 304 stainless steel. Using high-tech anti-corrosion surface treatment technology, suitable for long-term highly corrosive environment of offshore oil platforms, oil drilling platform, chlor-alkali, vulcanization cyanide, etc.
- A full range of high conductivity material accelerate convection cooling structure, effective guarantee long-term use in high temperature environments.
- Variety of light distribution, variety of installation types, an effective solution to beautify workshop and device platform.
- The shell is made of high-tech surface coating technology, corrosion resistant, waterproof and dust proof, suitable for harsh environments.
- Optoelectronic integrated technology, no dark spot, no ghosting, the average light efficiency of whole lamp can reach to 120 lm/W, energy-saving is 60% more than Metal Halide Lamp.
- Taiwan Meanwell driver or driver with same quality, power factor above 0.98, high reliability and long time service life.
- Independent wiring chamber, safe and easy installation and maintenance.
- Quick replay light source without welding.
- Intelligent control functions can be realized. (Dimming: 1-10VDC, PWM, Carrier, DALI, etc.)

Main Specification

Item	Technical Parameters
Input voltage (V)	90~264VAC
Rated frequency	50Hz / 60Hz
CRI (Ra)	70 (80 optional)
Life time (h)	50,000
CCT	5000K(3000K/4000K optional)
Cable entry	M20×1.5, G3/4", NPT1/2"
Terminals	Multi core: ≤4mm ²
	Single core: ≤6mm ²
Dimension (mm)	295×330×350
Net weight (kg)	7.5

Ordering Reference

Ordering reference	Picture	Rated Wattage (W)	Light output (lm)	Space height ratio	Mounting height (m)	Light distribution Curve(1000cd/lm)	Equivalent to MH
BC9307S□-L100-60°×80°		100W	11800	1.25	8~12m		250W
BC9307S□-L120-60°×80°		120W	13600				> 250W
BC9307S□-L150-60°×80°		150W	17300		10~15m		400W
BC9307S□-L200-60°×80°		200W	23300				> 400W
BC9307S□-L240-60°×80°		240W	26700		15~20m		600W~800W

Proiettore industriale IP66 ATEX BC9307S LED

VoltNexT

Ordering Reference

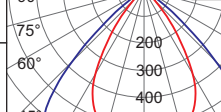
Ordering reference	Picture	Rated Wattage (W)	Light output (lm)	Space height ratio	Mounting height (m)	Light distribution curve(1000cd/lm)	Equivalent to
							MH
BC9307S□-L100-90°×110°		100W	11000	1.75	8~12m		250W
BC9307S□-L120-90°×110°		120W	12600				>250W
BC9307S□-L150-90°×110°		150W	16000		10~15m		400W
BC9307S□-L200-90°×110°		200W	22000				>400W
BC9307S□-L240-90°×110°		240W	25300		15~20m		600W~800W

Note 1: Lens can be customized 40°, 60°, 80°, 100°

Note 2: order number "□" according to the actual installation needs fill in 1 or 2, S1 straight stent, S2 angle bracket.

Drawing of dimension (Dimensions in mm)

Seat mounting

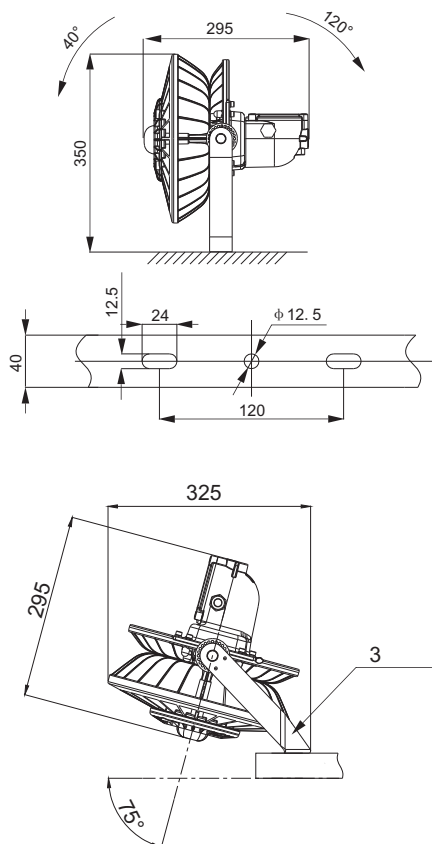

Side wall mounting

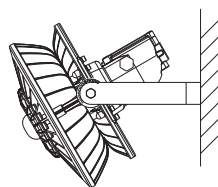

Pole mounting

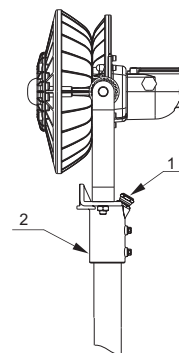
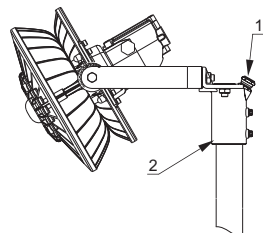

Accessories ordering information(optional)

Ordering reference	Item no	Specification	quantity
P23	3	Inclined bracket	1

Accessories ordering information(optional)

Ordering reference	Item no	Specification	quantity	note
P07	1	Water proof plug M20	1	φ 8~ φ 12mm cable
	2	Vertical Mounting pole	1	φ 40~ φ 50mm pole

Proiettore industriale IP66 ATEX BC9307P LED

VoltNexT



IECEX

ATEX

CE

RoHS
LM79
LM84

IP
66

Ta
40/55

Ta
-50



Ex marking: Ex db e IIC T4/T3 Gb
Ex tb IIC T130°C/T195°C Db,IP66

Application

- Ideal to be used in the oilfield, chemical industry, offshore drilling platform, steel industry, petroleum etc.
- Gas explosive environment: Group IIA,IIB,IIC.
- Zone 1,zone 2; zone 21,zone 22.





Characteristics

- It is made using a special aluminum housing, all exposed fasteners adopt 304 stainless steel. Using high-tech anti-corrosion surface treatment technology, suitable for long-term highly corrosive environment of offshore oil platforms, oil drilling platform, chlor-alkali, vulcanization cyanide, etc.
- A full range of high conductivity material accelerate convection cooling structure, effective guarantee long-term use in high temperature environments.
- Variety of light distribution, variety of installation types, an effective solution to beautify workshop and device platform.
- The shell is made of high-tech surface coating technology, corrosion resistant, waterproof and dust proof, suitable for harsh environments.
- Optoelectronic integrated technology, no dark spot, no ghosting, the average light efficiency of whole lamp can reach to 120 lm/W, energy-saving is 60% more than Metal Halide Lamp.
- Taiwan Meanwell driver or driver with same quality, power factor above 0.98, high reliability and long time service life.
- Independent wiring chamber, safe and easy installation and maintenance.
- Quick replay light source without welding.
- Intelligent control functions can be realized.(Dimming: 1-10VDC, PWM, Carrier, DALI, etc.)

Main Specification





Item	Technical Parameters
Input voltage (V)	90~264VAC
Rated frequency	50Hz / 60Hz
CRI (Ra)	70 (80 optional)
Life time (h)	50,000
CCT	5000K(3000K/4000K optional)
Cable entry	M20×1.5, M25×1.5, G3/4", NPT1/2", NPT3/4"
Terminals	Multi core: $\leq 2.5\text{mm}^2$
	Single core: $\leq 4\text{mm}^2$
Dimension (mm)	$\phi 300 \times 290$
Net weight (kg)	6.4

Ordering reference

Ordering reference	Picture	Rated Wattage (W)	Light output (lm)	Space height ratio	Mounting height (m)	Light distribution curve(1000cd/lm)	Equivalent to	
							MH	
BC9307P-L100-40°		100W	11300	0.7	8~12m		250W	
BC9307P-L120-40°		120W	13000				>250W	
BC9307P-L150-40°		150W	16500		10~20m		400W	
BC9307P-L180-40°		180W	17500				>400W	

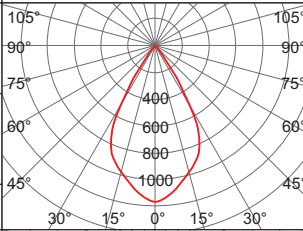
Proiettore industriale IP66 ATEX BC9307P LED

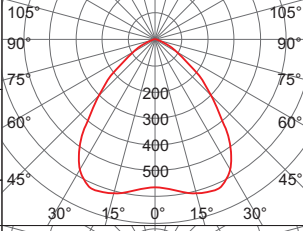
VoltNexT

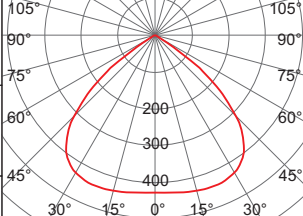
Ordering reference	Picture	Rated Wattage (W)	Light output (lm)	Space height ratio	Mounting height (m)	Light distribution curve(1000cd/lm)	Equivalent to MH
BC9307P-L100-60°		100W	11200	0.9	8~12m		250W
BC9307P-L120-60°		120W	12900				> 250W
BC9307P-L150-60°		150W	16500		10~20m		400W
BC9307P-L200-60°		200W	23100				>400W
BC9307P-L240-60°		240W	26700		20~30m		600W~800W
BC9307P-L100-80°		100W	11500	1.35	8~12m		250W
BC9307P-L120-80°		120W	13200				> 250W
BC9307P-L150-80°		150W	16800		10~15m		400W
BC9307P-L200-80°		200W	23700				>400W
BC9307P-L240-80°		240W	27200		15~25m		600W~800W
BC9307P-L100-100°		100W	11600	1.4	8~12m		250W
BC9307P-L120-100°		120W	13400				> 250W
BC9307P-L150-100°		150W	17000		10~15m		400W
BC9307P-L200-100°		200W	23900				>400W
BC9307P-L240-100°		240W	27400		15~20m		600W~800W

Note 1: Lens can be customized 60°×80°, 90°×100°, 200°

Drawing of dimension (Dimensions in mm)

Pole mounting

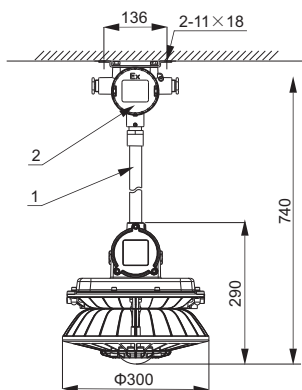

Wall mounting 150deg

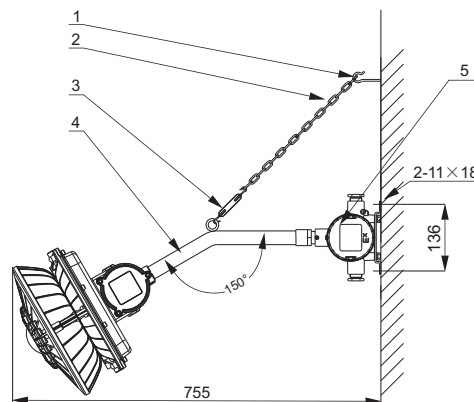

Accessories order information(Pole mounting)

Ordering reference	Item no.	Specification	quantity
P01	1	G3/4" pole 30cm	1
BHD01	2	Explosion proof junction box	1

Accessories order information(Wall mounting 150deg)

Ordering reference	Item no.	Specification	quantity
P03	1	Expansion screw hook	1
	2	Chain	1
	3	C-C turn buckle	1
	4	G3/4" bend pipe 150°	1
BHD01	5	Explosion proof junction box	1

Proiettore industriale IP66 ATEX BC9307S Spot LED

VoltNexT



Ex marking: Ex db e IIC T4/T3 Gb
Ex tb IIC T130°C/T195°C Db,IP66

Application

- Ideal to be used in the oilfield, chemical industry, offshore drilling platform, steel industry, petroleum etc.
- Gas explosive environment: Group IIA, IIB, IIC.
- Zone 1, zone 2; zone 21, zone 22.



Characteristics

- It is made using a special aluminum housing, all exposed fasteners and bracket adopt 304 stainless steel. Using high-tech anti-corrosion surface treatment technology, suitable for long-term highly corrosive environment of offshore oil platforms, oil drilling platform, chlor-alkali, vulcanization cyanide, etc.
- A full range of high conductivity material accelerate convection cooling structure, effective guarantee long-term use in high temperature environments.
- Variety of light distribution, variety of installation types, an effective solution to beautify workshop and device platform.
- The shell is made of high-tech surface coating technology, corrosion resistant, waterproof and dust proof, suitable for harsh environments.
- Optoelectronic integrated technology, no dark spot, no ghosting, the average light efficiency of whole lamp can reach to 120 lm/W, energy-saving is 60% more than Metal Halide Lamp.
- Taiwan Meanwell driver or driver with same quality, power factor above 0.98, high reliability and long time service life.
- Independent wiring chamber, safe and easy installation and maintenance.
- Quick replay light source without welding.
- Intelligent control functions can be realized. (Dimming: 1-10VDC, PWM, Carrier, DALI, etc.)

Main Specification

Item	Technical Parameters
Input voltage (V)	90~264VAC
Rated frequency	50Hz / 60Hz
CRI (Ra)	70 (80 optional)
Life time (h)	50,000
CCT	5000K(3000K/4000K optional)
Cable entry	M20×1.5, NPT1/2"
Terminals	Multi core: ≤4mm ²
	Single core: ≤6mm ²
Dimension (mm)	341×330×350
Net weight (kg)	8.1

Ordering Reference

Ordering reference	Picture	Rated Wattage (W)	Light output (lm)	Light distribution curve(1000cd/lm)	Equivalent to
					MH
BC9307S□-L100-18°		100W	10000		250W
BC9307S□-L120-18°		120W	11500		> 250W
BC9307S□-L150-18°		150W	14600		400W
BC9307S□-L180-18°		180W	15500		> 400W

Proiettore industriale IP66 ATEX BC9307S Spot LED

VoltNexT

Ordering Reference

Ordering reference	Picture	Rated Wattage (W)	Light output (lm)	Light distribution curve(1000cd/lm)	Equivalent to
					MH
BC9307S□-L200-25°		200W	20300		>400W
BC9307S□-L240-25°		240W	23500		400W~600W

Note : order number "□" according to the actual installation needs fill in 1 or 2, S1 straight stent, S2 angle bracket.

Drawing of dimension (Dimensions in mm)

Seat mounting

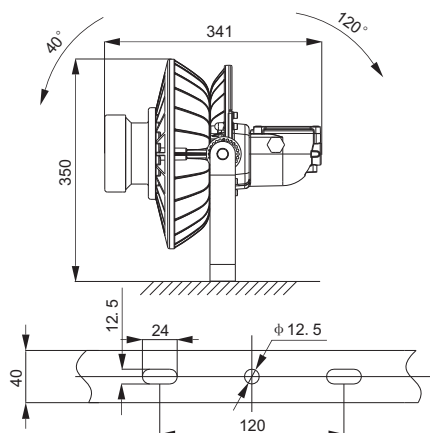

Side wall mounting

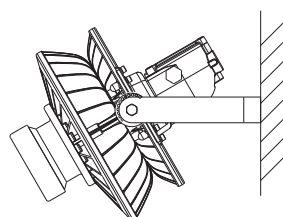

BC9307S1

Pole mounting

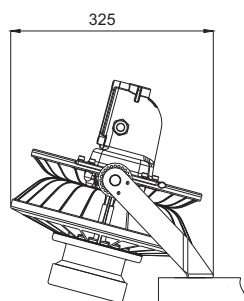
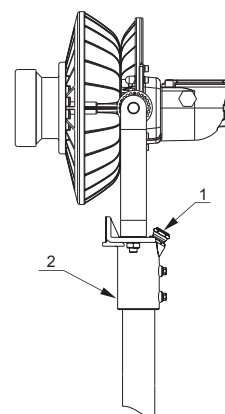
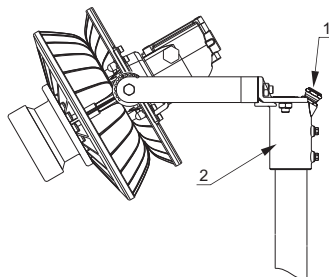

BC9307S2

Accessories ordering information(optional)

Ordering reference	Item no	Specification	quantity	note
P07	1	Water proof plug M20	1	φ 8~ φ 12mm cable
	2	Vertical Mounting pole	1	φ 40~ φ 50mm pole